

KAPTIV-CS-HP-S

Zero air loss drain up to 50 bar in stainless steel

PRODUCT FEATURES

The KAPTIV-CS-HP-S is a stainless steel electronically operated level sensed condensate drain which offers zero air-loss during the condensate discharge cycle for applications up to 50 bar.

The KAPTIV-CS-HP-S can be installed in all compressed air system components up to 100 m³/min regardless size and climate zone – Only 1 model needed!

The robust industrial housing, the alarm feature and the 2/2 way direct acting valve assembly make the KAPTIV-CS-HP-S a reliable solution for all compressed air system applications.

The KAPTIV-CS-HP-S offers an integrated mesh strainer (to prevent large particles from entering the valve orifice), is easy to disassemble and is service friendly.



COMMERCIAL BENEFITS

- Stainless steel zero air-loss draining solution
- Capacitive level sensing technology saves air, energy and money
- 1 Model covers up to 100 m³/min. compressor capacity
- No sizing charts required
- Operating pressure up to 50 bar

TECHNICAL ADVANTAGES

- Alarm function (N/O or N/C) as a standard
- Easy installation
- Visual display of operating status
- Integrated strainer
- Direct acting valve assembly, ensuring reliable discharge operation
- Robust stainless steel housing

KAPTIV-CS-HP-S

Zero air loss drain up to 50 bar in stainless steel

DIMENSIONS

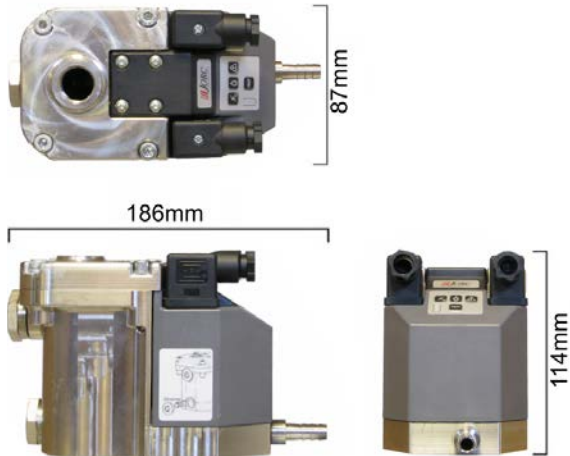

Multiple (3) inlet options

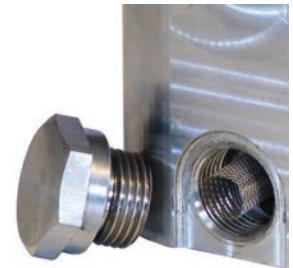

Integrated mesh strainer to protect the valve

TECHNICAL SPECIFICATIONS

Max. compressor capacity	100 m ³ /min.
Pressure range	0 - 50 bar
Valve type	2/2 way, direct acting
Valve orifice	1.8 mm
Valve seals	FPM
Inlet connections	1/2" BSP or NPT, 3 inlet options
Inlet height	11 cm (top) and 7.5 & 1.5 cm (side)
Outlet connection	1/4" BSP
Medium temperature	1 - 50 °C
Ambient temperature	1 - 50 °C
Supply voltage options	230VAC / 115VAC / 24VAC / 24VDC
Power and alarm connectors	DIN 43650-B
Serviceable valve	Yes
TEST feature	Yes
Environmental protection	IP65 (NEMA4)
Integrated mesh strainer	Yes
Alarm feature type	Contact output switch (voltage free) available in two versions: A1 and A2*
Housing material	Stainless steel

*A1 = Normally open contacts, closed when in alarm phase. LED on the drain is OFF when in operation and ON when in alarm mode.

A2 = Normally closed contacts, open when in alarm phase. LED on the drain is ON when in operation and OFF when in alarm mode.

JORC is NEN - EN - ISO 9001:2015 certified

Information provided herewith is believed to be accurate and reliable. However, no responsibility is assumed for its use or for any infringement of patents or rights of others, which may result from its use. In addition, JORC reserves the right to revise information without notice and without incurring any obligation.

JORC Industrial BV Tel +31 45 5242427
 Pretoriastraat 28
 NL-6413 NN Heerlen info@jorc.nl
 The Netherlands www.jorc.eu

